



Lymore Gardens,

Offers In Excess Of £375,000

FOR SALE



- Two Double Bedrooms
- Two Reception Rooms
- Spacious
- Mid-Terrace
- Good Size Garden

THE PROPERTY

Ideally positioned, just a short distance from Oldfield Park railway station, the property benefits from excellent transport links into the city centre and beyond. This is a well proportioned two-bedroom home on Lymore Gardens, which offers spacious accommodation across two floors.

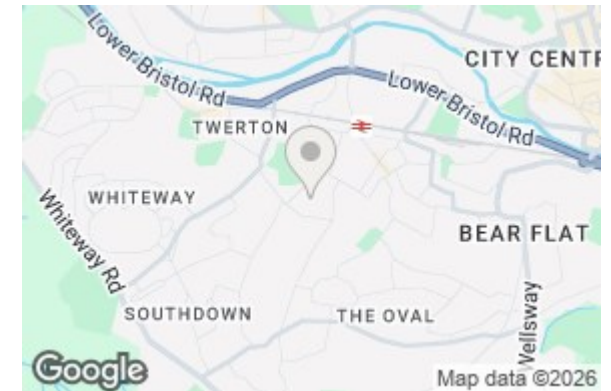
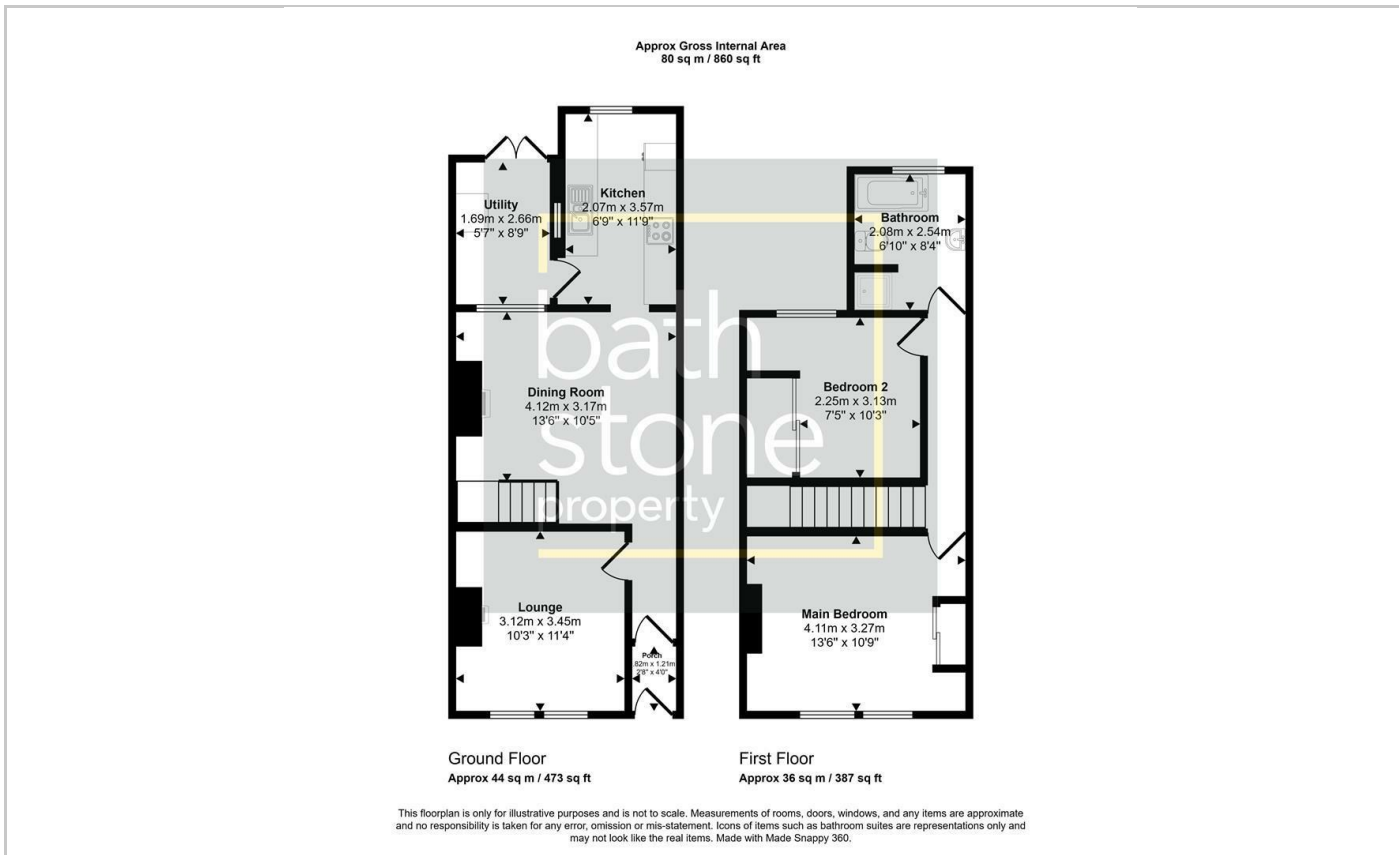

Energy Efficiency Rating		Current	Potential
Very energy efficient - lower running costs			
(92 plus) A			
(81-91) B			
(69-80) C			
(55-68) D			
(39-54) E			
(21-38) F			
(1-20) G			
Not energy efficient - higher running costs			
England & Wales		EU Directive 2002/91/EC	